

1 座 1 樓平面圖

Block 1 1/F Floor Plan



圖例 NOTATION

BATH	浴室	Bathroom
HR	消防喉轆	Hose Reel
KIT	廚房	Kitchen
LIV/DIN	客 / 飯廳	Living/Dining Room
P.D.	管槽	Pipe Duct
RS&MRR	垃圾及物料回收室	Refuse Storage and Material Recovery Room
W.M.C.	水錶櫃	Water Meter Cupboard
TELECOM AND ELV. RM.	電訊及特低壓電掣機房	Telecommunication and Extra-Low Voltage Cable Room
ELEC. METER RM.	電錶房	Electrical Meter Room
SWITCH RM.	電掣房	Switch Room
P.D. DOG HOUSE	室外管道檢修井	Pipe Duct Dog House
	簷篷 / 平台	Canopy/Flat Roof

1. 每個住宅物業的層與層之間的高度為2.75米。
2. 每個住宅物業的樓板(不包括灰泥)的厚度為160毫米及215毫米。
3. 因住宅物業的較高樓層的結構牆的厚度遞減，較高樓層的內部面積，一般比較低樓層的內部面積稍大。(不適用於該發展項目)。

註：平面圖所列之數字為以毫米標示之建築結構尺寸。

1. The floor-to-floor height of each residential property is 2.75m.
2. The thicknesses of the floor slabs (excluding plaster) of each residential property are 160mm and 215mm.
3. The internal areas of the residential properties on the upper floors will generally be slightly larger than those on the lower floors because of the reducing thickness of the structural walls on the upper floors. (Not applicable to the Development)

Note: The dimensions on the floor plan are all structural dimensions in millimetre.

發展項目的住宅物業的樓面平面圖  
Floor Plans of Residential Properties in the Development



圖例 NOTATION

BATH	浴室	Bathroom
HR	消防喉轆	Hose Reel
KIT	廚房	Kitchen
LIV/DIN	客 / 飯廳	Living/Dining Room
P.D.	管槽	Pipe Duct
RS&MRR	垃圾及物料回收室	Refuse Storage and Material Recovery Room
W.M.C.	水錶櫃	Water Meter Cupboard
TELECOM AND ELV. RM.	電訊及特低壓電掣機房	Telecommunication and Extra-Low Voltage Cable Room
ELEC. METER RM.	電錶房	Electrical Meter Room
SWITCH RM.	電掣房	Switch Room

1. 每個住宅物業的層與層之間的高度為2.75米。
2. 每個住宅物業的樓板(不包括灰泥)的厚度為160毫米及215毫米。
3. 因住宅物業的較高樓層的結構牆的厚度遞減，較高樓層的內部面積，一般比較低樓層的內部面積稍大。(不適用於該發展項目)

1. The floor-to-floor height of each residential property is 2.75m.
2. The thicknesses of the floor slabs (excluding plaster) of each residential property are 160mm and 215mm.
3. The internal areas of the residential properties on the upper floors will generally be slightly larger than those on the lower floors because of the reducing thickness of the structural walls on the upper floors. (Not applicable to the Development)

註：平面圖所列之數字為以毫米標示之建築結構尺寸。

Note: The dimensions on the floor plan are all structural dimensions in millimetre.

發展項目的住宅物業的樓面平面圖  
Floor Plans of Residential Properties in the Development

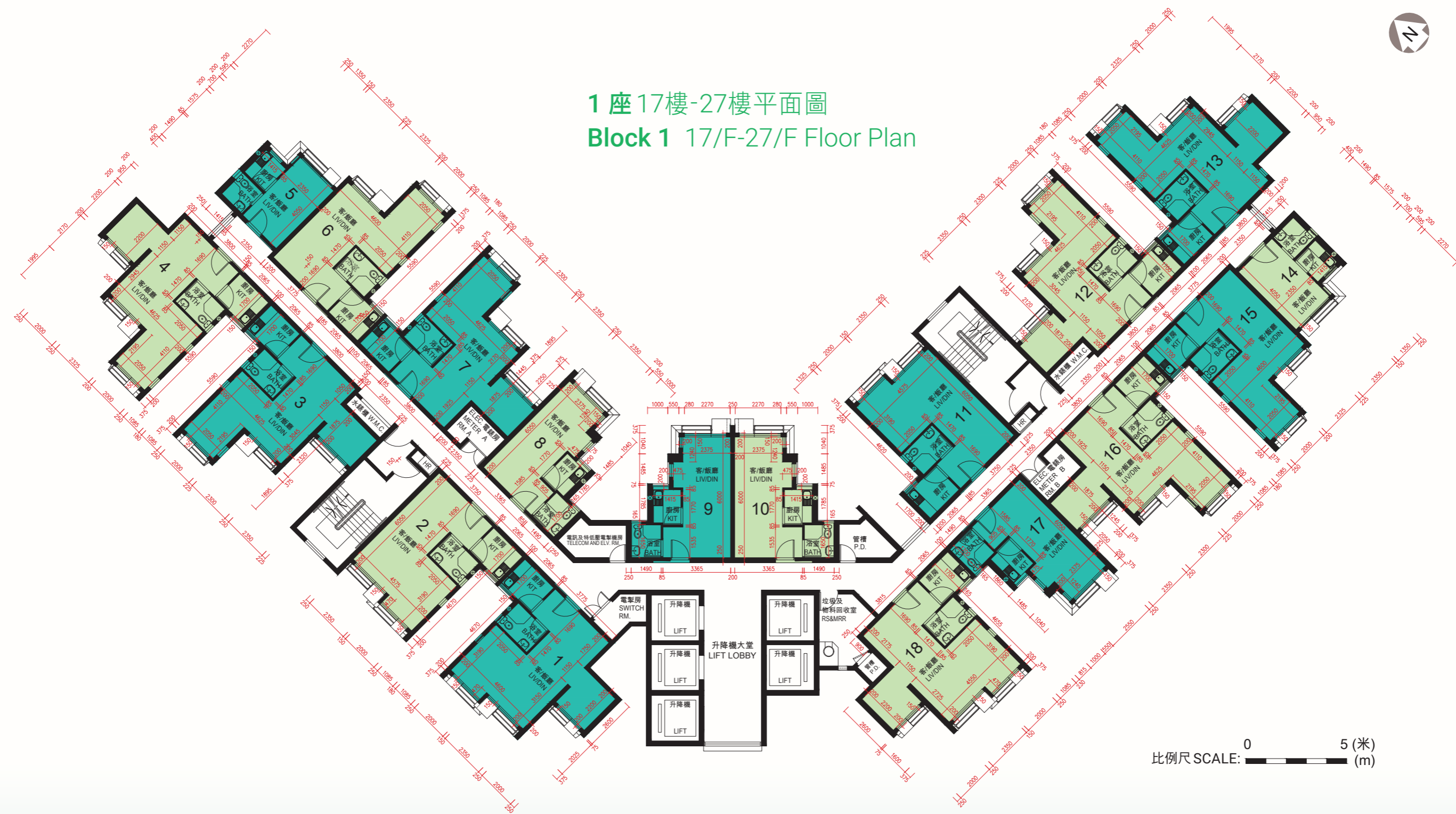

圖例 NOTATION

BATH	浴室	Bathroom
HR	消防喉轆	Hose Reel
KIT	廚房	Kitchen
LIV/DIN	客 / 飯廳	Living/Dining Room
P.D.	管槽	Pipe Duct
RS&MRR	垃圾及物料回收室	Refuse Storage and Material Recovery Room
W.M.C.	水錶櫃	Water Meter Cupboard
TELECOM AND ELV. RM.	電訊及特低壓電掣機房	Telecommunication and Extra-Low Voltage Cable Room
ELEC. METER RM.	電錶房	Electrical Meter Room
SWITCH RM.	電掣房	Switch Room

1.

每個住宅物業的層與層之間的高度為2.75米。
2.

每個住宅物業的樓板(不包括灰泥)的厚度為160毫米及215毫米。
3.

因住宅物業的較高樓層的結構牆的厚度遞減，較高樓層的內部面積，一般比較低樓層的內部面積稍大。(不適用於該發展項目)

註：平面圖所列之數字為以毫米標示之建築結構尺寸。

1.

The floor-to-floor height of each residential property is 2.75m.
2.

The thicknesses of the floor slabs (excluding plaster) of each residential property are 160mm and 215mm.
3.

The internal areas of the residential properties on the upper floors will generally be slightly larger than those on the lower floors because of the reducing thickness of the structural walls on the upper floors. (Not applicable to the Development)

Note: The dimensions on the floor plan are all structural dimensions in millimetre.

發展項目的住宅物業的樓面平面圖  
Floor Plans of Residential Properties in the Development

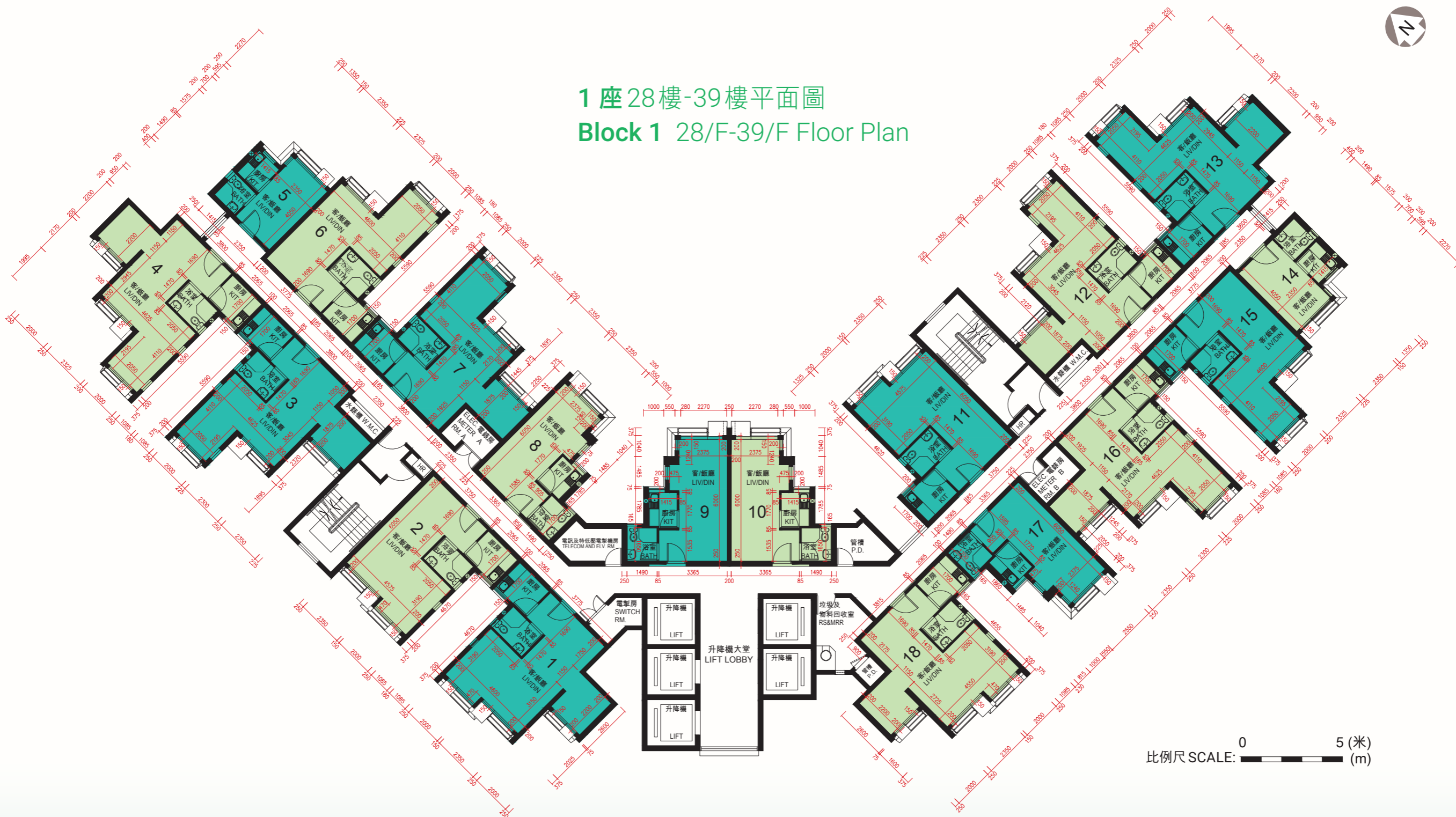

圖例 NOTATION

BATH	浴室	Bathroom
HR	消防喉轆	Hose Reel
KIT	廚房	Kitchen
LIV/DIN	客 / 飯廳	Living/Dining Room
P.D.	管槽	Pipe Duct
RS&MRR	垃圾及物料回收室	Refuse Storage and Material Recovery Room
W.M.C.	水錶櫃	Water Meter Cupboard
TELECOM AND ELV. RM.	電訊及特低壓電掣機房	Telecommunication and Extra-Low Voltage Cable Room
ELEC. METER RM.	電錶房	Electrical Meter Room
SWITCH RM.	電掣房	Switch Room

1.

每個住宅物業的層與層之間的高度為2.75米(39樓除外)。  
39樓每個住宅物業的層與層之間的高度為2.79米。
2.

每個住宅物業的樓板(不包括灰泥)的厚度為160毫米及215毫米(39樓除外)。  
39樓每個住宅物業的樓板(不包括灰泥)的厚度為200毫米。
3.

因住宅物業的較高樓層的結構牆的厚度遞減，較高樓層的內部面積，一般比較低樓層的內部面積稍大。(不適用於該發展項目)

註：平面圖所列之數字為以毫米標示之建築結構尺寸。

1.

The floor-to-floor height of each residential property is 2.75m (except 39/F).  
The floor-to-floor height of each residential property on 39/F is 2.79m.
2.

The thicknesses of the floor slabs (excluding plaster) of each residential property are 160mm and 215mm (except 39/F).  
The thickness of the floor slab (excluding plaster) of each residential property on 39/F is 200mm.
3.

The internal areas of the residential properties on the upper floors will generally be slightly larger than those on the lower floors because of the reducing thickness of the structural walls on the upper floors. (Not applicable to the Development)

Note: The dimensions on the floor plan are all structural dimensions in millimetre.

發展項目的住宅物業的樓面平面圖  
Floor Plans of Residential Properties in the Development

2座1樓平面圖  
Block 2 1/F Floor Plan



圖例 NOTATION

BATH	浴室	Bathroom
HR	消防喉轆	Hose Reel
KIT	廚房	Kitchen
LIV/DIN	客 / 飯廳	Living/Dining Room
P.D.	管槽	Pipe Duct
RS&MRR	垃圾及物料回收室	Refuse Storage and Material Recovery Room
W.M.C.	水錶櫃	Water Meter Cupboard
TELECOM AND ELV. RM.	電訊及特低壓電掣機房	Telecommunication and Extra-Low Voltage Cable Room
ELEC. METER RM.	電錶房	Electrical Meter Room
SWITCH RM.	電掣房	Switch Room
P.D. DOG HOUSE	室外管道檢修井	Pipe Duct Dog House
	簷篷 / 平台	Canopy/Flat Roof

1.

每個住宅物業的層與層之間的高度為2.75米。
2.

每個住宅物業的樓板(不包括灰泥)的厚度為160毫米及215毫米。
3.

因住宅物業的較高樓層的結構牆的厚度遞減，較高樓層的內部面積，一般比較低樓層的內部面積稍大。(不適用於該發展項目)

1.

The floor-to-floor height of each residential property is 2.75m.
2.

The thicknesses of the floor slabs (excluding plaster) of each residential property are 160mm and 215mm.
3.

The internal areas of the residential properties on the upper floors will generally be slightly larger than those on the lower floors because of the reducing thickness of the structural walls on the upper floors. (Not applicable to the Development).

註：平面圖所列之數字為以毫米標示之建築結構尺寸。

Note: The dimensions on the floor plan are all structural dimensions in millimetre.

2座2樓-16樓平面圖  
Block 2 2/F-16/F Floor Plan



圖例 NOTATION

BATH	浴室	Bathroom
HR	消防喉轆	Hose Reel
KIT	廚房	Kitchen
LIV/DIN	客 / 飯廳	Living/Dining Room
P.D.	管槽	Pipe Duct
RS&MRR	垃圾及物料回收室	Refuse Storage and Material Recovery Room
W.M.C.	水錶櫃	Water Meter Cupboard
TELECOM AND ELV. RM.	電訊及特低壓電掣機房	Telecommunication and Extra-Low Voltage Cable Room
ELEC. METER RM.	電錶房	Electrical Meter Room
SWITCH RM.	電掣房	Switch Room

1.

每個住宅物業的層與層之間的高度為2.75米。
2.

每個住宅物業的樓板(不包括灰泥)的厚度為160毫米及215毫米。
3.

因住宅物業的較高樓層的結構牆的厚度遞減，較高樓層的內部面積，一般比較低樓層的內部面積稍大。(不適用於該發展項目)

註：平面圖所列之數字為以毫米標示之建築結構尺寸。

1.

The floor-to-floor height of each residential property is 2.75m.
2.

The thicknesses of the floor slabs (excluding plaster) of each residential property are 160mm and 215mm.
3.

The internal areas of the residential properties on the upper floors will generally be slightly larger than those on the lower floors because of the reducing thickness of the structural walls on the upper floors. (Not applicable to the Development)

Note: The dimensions on the floor plan are all structural dimensions in millimetre.

發展項目的住宅物業的樓面平面圖  
Floor Plans of Residential Properties in the Development

2座17樓-26樓平面圖  
Block 2 17/F-26/F Floor Plan



圖例 NOTATION

BATH	浴室	Bathroom
HR	消防喉轆	Hose Reel
KIT	廚房	Kitchen
LIV/DIN	客 / 飯廳	Living/Dining Room
P.D.	管槽	Pipe Duct
RS&MRR	垃圾及物料回收室	Refuse Storage and Material Recovery Room
W.M.C.	水錶櫃	Water Meter Cupboard
TELECOM AND ELV. RM.	電訊及特低壓電掣機房	Telecommunication and Extra-Low Voltage Cable Room
ELEC. METER RM.	電錶房	Electrical Meter Room
SWITCH RM.	電掣房	Switch Room

1. 每個住宅物業的層與層之間的高度為2.75米。
2. 每個住宅物業的樓板(不包括灰泥)的厚度為160毫米及215毫米。
3. 因住宅物業的較高樓層的結構牆的厚度遞減，較高樓層的內部面積，一般比較低樓層的內部面積稍大。(不適用於該發展項目)

1. The floor-to-floor height of each residential property is 2.75m.
2. The thicknesses of the floor slabs (excluding plaster) of each residential property are 160mm and 215mm.
3. The internal areas of the residential properties on the upper floors will generally be slightly larger than those on the lower floors because of the reducing thickness of the structural walls on the upper floors. (Not applicable to the Development)

註：平面圖所列之數字為以毫米標示之建築結構尺寸。

Note: The dimensions on the floor plan are all structural dimensions in millimetre.

## 2座27樓-36樓平面圖

## Block 2 27/F-36/F Floor Plan



圖例 NOTATION

BATH	浴室	Bathroom
HR	消防喉轆	Hose Reel
KIT	廚房	Kitchen
LIV/DIN	客 / 飯廳	Living/Dining Room
P.D.	管槽	Pipe Duct
RS&MRR	垃圾及物料回收室	Refuse Storage and Material Recovery Room
W.M.C.	水錶櫃	Water Meter Cupboard
TELECOM AND ELV. RM.	電訊及特低壓電掣機房	Telecommunication and Extra-Low Voltage Cable Room
ELEC. METER RM.	電錶房	Electrical Meter Room
SWITCH RM.	電掣房	Switch Room

1. 每個住宅物業的層與層之間的高度為2.75米(36樓除外)。  
36樓每個住宅物業的層與層之間的高度為2.79米。
2. 每個住宅物業的樓板(不包括灰泥)的厚度為160毫米及215毫米(36樓除外)。  
36樓每個住宅物業的樓板(不包括灰泥)的厚度為200毫米。
3. 因住宅物業的較高樓層的結構牆的厚度遞減，較高樓層的內部面積，一般比較低樓層的內部面積稍大。(不適用於該發展項目)

1. The floor-to-floor height of each residential property is 2.75m (except 36/F).  
The floor-to-floor height of each residential property on 36/F is 2.79m.
2. The thicknesses of the floor slabs (excluding plaster) of each residential property are 160mm and 215mm (except 36/F).  
The thickness of the floor slab (excluding plaster) of each residential property on 36/F is 200mm.
3. The internal areas of the residential properties on the upper floors will generally be slightly larger than those on the lower floors because of the reducing thickness of the structural walls on the upper floors. (Not applicable to the Development)

註：平面圖所列之數字為以毫米標示之建築結構尺寸。

Note: The dimensions on the floor plan are all structural dimensions in millimetre.

### Block 3 1F Floor Plan



圖例 NOTATION

BATH	浴室	Bathroom
HR	消防喉轆	Hose Reel
KIT	廚房	Kitchen
LIV/DIN	客 / 飯廳	Living/Dining Room
P.D.	管槽	Pipe Duct
RS&MRR	垃圾及物料回收室	Refuse Storage and Material Recovery Room
W.M.C.	水錶櫃	Water Meter Cupboard
TELECOM AND ELV. RM.	電訊及特低壓電掣機房	Telecommunication and Extra-Low Voltage Cable Room
ELEC. METER RM.	電錶房	Electrical Meter Room
P.D. DOG HOUSE	室外管道檢修井	Pipe Duct Dog House
	簷篷 / 平台	Canopy/Flat Roof

1.

每個住宅物業的層與層之間的高度為2.75米。
2.

每個住宅物業的樓板(不包括灰泥)的厚度為160毫米及215毫米。
3.

因住宅物業的較高樓層的結構牆的厚度遞減，較高樓層的內部面積，一般比較低樓層的內部面積稍大。(不適用於該發展項目)

註：平面圖所列之數字為以毫米標示之建築結構尺寸。

1.

The floor-to-floor height of each residential property is 2.75m.
2.

The thicknesses of the floor slabs (excluding plaster) of each residential property are 160mm and 215mm.
3.

The internal areas of the residential properties on the upper floors will generally be slightly larger than those on the lower floors because of the reducing thickness of the structural walls on the upper floors. (Not applicable to the Development)

Note: The dimensions on the floor plan are all structural dimensions in millimetre.

3座2樓-19樓平面圖  
Block 3 2/F-19/F Floor Plan



圖例 NOTATION

BATH	浴室	Bathroom
HR	消防喉轆	Hose Reel
KIT	廚房	Kitchen
LIV/DIN	客 / 飯廳	Living/Dining Room
P.D.	管槽	Pipe Duct
RS&MRR	垃圾及物料回收室	Refuse Storage and Material Recovery Room
W.M.C.	水錶櫃	Water Meter Cupboard
TELECOM AND ELV. RM.	電訊及特低壓電掣機房	Telecommunication and Extra-Low Voltage Cable Room
ELEC. METER RM.	電錶房	Electrical Meter Room

1. 每個住宅物業的層與層之間的高度為2.75米。
2. 每個住宅物業的樓板(不包括灰泥)的厚度為160毫米及215毫米。
3. 因住宅物業的較高樓層的結構牆的厚度遞減，較高樓層的內部面積，一般比較低樓層的內部面積稍大。(不適用於該發展項目)

註：平面圖所列之數字為以毫米標示之建築結構尺寸。

1. The floor-to-floor height of each residential property is 2.75m.
2. The thicknesses of the floor slabs (excluding plaster) of each residential property are 160mm and 215mm.
3. The internal areas of the residential properties on the upper floors will generally be slightly larger than those on the lower floors because of the reducing thickness of the structural walls on the upper floors. (Not applicable to the Development)

Note: The dimensions on the floor plan are all structural dimensions in millimetre.

3座20樓-34樓平面圖  
Block 3 20/F-34/F Floor Plan



圖例 NOTATION

BATH	浴室	Bathroom
HR	消防喉轆	Hose Reel
KIT	廚房	Kitchen
LIV/DIN	客 / 飯廳	Living/Dining Room
P.D.	管槽	Pipe Duct
RS&MRR	垃圾及物料回收室	Refuse Storage and Material Recovery Room
W.M.C.	水錶櫃	Water Meter Cupboard
TELECOM AND ELV. RM.	電訊及特低壓電掣機房	Telecommunication and Extra-Low Voltage Cable Room
ELEC. METER RM.	電錶房	Electrical Meter Room

1. 每個住宅物業的層與層之間的高度為2.75米。
2. 每個住宅物業的樓板(不包括灰泥)的厚度為160毫米及215毫米。
3. 因住宅物業的較高樓層的結構牆的厚度遞減，較高樓層的內部面積，一般比較低樓層的內部面積稍大。(不適用於該發展項目)

1. The floor-to-floor height of each residential property is 2.75m.
2. The thicknesses of the floor slabs (excluding plaster) of each residential property are 160mm and 215mm .
3. The internal areas of the residential properties on the upper floors will generally be slightly larger than those on the lower floors because of the reducing thickness of the structural walls on the upper floors. (Not applicable to the Development)

註：平面圖所列之數字為以毫米標示之建築結構尺寸。

Note: The dimensions on the floor plan are all structural dimensions in millimetre.



### 3座35樓-36樓平面圖

### Block 3 35/F-36/F Floor Plan



圖例 NOTATION

BATH	浴室	Bathroom
HR	消防喉轆	Hose Reel
KIT	廚房	Kitchen
LIV/DIN	客 / 飯廳	Living/Dining Room
P.D.	管槽	Pipe Duct
RS&MRR	垃圾及物料回收室	Refuse Storage and Material Recovery Room
W.M.C.	水錶櫃	Water Meter Cupboard
TELECOM AND ELV. RM.	電訊及特低壓電掣機房	Telecommunication and Extra-Low Voltage Cable Room
ELEC. METER RM.	電錶房	Electrical Meter Room

1. 每個住宅物業的層與層之間的高度為2.75米(36樓除外)。  
36樓每個住宅物業的層與層之間的高度為2.79米。
2. 每個住宅物業的樓板(不包括灰泥)的厚度為160毫米及215毫米(36樓除外)。  
36樓每個住宅物業的樓板(不包括灰泥)的厚度為200毫米。
3. 因住宅物業的較高樓層的結構牆的厚度遞減，較高樓層的內部面積，一般比較低樓層的內部面積稍大。(不適用於該發展項目)

註：平面圖所列之數字為以毫米標示之建築結構尺寸。

1. The floor-to-floor height of each residential property is 2.75m (except 36/F).  
The floor-to-floor height of each residential property on 36/F is 2.79m.
2. The thickness of the floor slab (excluding plaster) of each residential property are 160mm and 215mm (except 36/F).  
The thickness of the floor slab (excluding plaster) of each residential property on 36/F is 200mm.
3. The internal areas of the residential properties on the upper floors will generally be slightly larger than those on the lower floors because of the reducing thickness of the structural walls on the upper floors. (Not applicable to the Development)

Note: The dimensions on the floor plan are all structural dimensions in millimetre.

發展項目的住宅物業的樓面平面圖  
Floor Plans of Residential Properties in the Development

4 座1樓平面圖  
Block 4 1/F Floor Plan



圖例 NOTATION

BATH	浴室	Bathroom
HR	消防喉轆	Hose Reel
KIT	廚房	Kitchen
LIV/DIN	客 / 飯廳	Living/Dining Room
P.D.	管槽	Pipe Duct
RS&MRR	垃圾及物料回收室	Refuse Storage and Material Recovery Room
W.M.C.	水錶櫃	Water Meter Cupboard
TELECOM AND ELV. RM.	電訊及特低壓電掣機房	Telecommunication and Extra-Low Voltage Cable Room
ELEC. METER RM.	電錶房	Electrical Meter Room
P.D. DOG HOUSE	室外管道檢修井	Pipe Duct Dog House
	簷篷 / 平台	Canopy/Flat Roof

1.

每個住宅物業的層與層之間的高度為2.75米。
2.

每個住宅物業的樓板 (不包括灰泥) 的厚度為160毫米及215毫米。
3.

因住宅物業的較高樓層的結構牆的厚度遞減，較高樓層的內部面積，一般比較低樓層的內部面積稍大。(不適用於該發展項目)

註：平面圖所列之數字為以毫米標示之建築結構尺寸。

1.

The floor-to-floor height of each residential property is 2.75m.
2.

The thicknesses of the floor slabs (excluding plaster) of each residential property are 160mm and 215mm.
3.

The internal areas of the residential properties on the upper floors will generally be slightly larger than those on the lower floors because of the reducing thickness of the structural walls on the upper floors. (Not applicable to the Development)

Note: The dimensions on the floor plan are all structural dimensions in millimetre.

4座2樓-19樓平面圖  
Block 4 2/F-19/F Floor Plan



圖例 NOTATION

BATH	浴室	Bathroom
HR	消防喉轆	Hose Reel
KIT	廚房	Kitchen
LIV/DIN	客 / 飯廳	Living/Dining Room
P.D.	管槽	Pipe Duct
RS&MRR	垃圾及物料回收室	Refuse Storage and Material Recovery Room
W.M.C.	水錶櫃	Water Meter Cupboard
TELECOM AND ELV. RM.	電訊及特低壓電掣機房	Telecommunication and Extra-Low Voltage Cable Room
ELEC. METER RM.	電錶房	Electrical Meter Room

1. 每個住宅物業的層與層之間的高度為2.75米。
2. 每個住宅物業的樓板(不包括灰泥)的厚度為160毫米及215毫米。
3. 因住宅物業的較高樓層的結構牆的厚度遞減，較高樓層的內部面積，一般比較低樓層的內部面積稍大。(不適用於該發展項目)

1. The floor-to-floor height of each residential property is 2.75m.
2. The thicknesses of the floor slabs (excluding plaster) of each residential property are 160mm and 215mm.
3. The internal areas of the residential properties on the upper floors will generally be slightly larger than those on the lower floors because of the reducing thickness of the structural walls on the upper floors. (Not applicable to the Development)

註：平面圖所列之數字為以毫米標示之建築結構尺寸。

Note: The dimensions on the floor plan are all structural dimensions in millimetre.

4 座 20樓-38樓平面圖  
Block 4 20/F-38/F Floor Plan



圖例 NOTATION

BATH	浴室	Bathroom
HR	消防喉轆	Hose Reel
KIT	廚房	Kitchen
LIV/DIN	客 / 飯廳	Living/Dining Room
P.D.	管槽	Pipe Duct
RS&MRR	垃圾及物料回收室	Refuse Storage and Material Recovery Room
W.M.C.	水錶櫃	Water Meter Cupboard
TELECOM AND ELV. RM.	電訊及特低壓電掣機房	Telecommunication and Extra-Low Voltage Cable Room
ELEC. METER RM.	電錶房	Electrical Meter Room

1. 每個住宅物業的層與層之間的高度為2.75米。
2. 每個住宅物業的樓板(不包括灰泥)的厚度為160毫米及215毫米。
3. 因住宅物業的較高樓層的結構牆的厚度遞減，較高樓層的內部面積，一般比較低樓層的內部面積稍大。(不適用於該發展項目)

1. The floor-to-floor height of each residential property is 2.75m.
2. The thicknesses of the floor slabs (excluding plaster) of each residential property are 160mm and 215mm.
3. The internal areas of the residential properties on the upper floors will generally be slightly larger than those on the lower floors because of the reducing thickness of the structural walls on the upper floors. (Not applicable to the Development)

註：平面圖所列之數字為以毫米標示之建築結構尺寸。

Note: The dimensions on the floor plan are all structural dimensions in millimetre.

4 座 39 樓平面圖  
Block 4 39/F Floor Plan



圖例 NOTATION

BATH	浴室	Bathroom
HR	消防喉轆	Hose Reel
KIT	廚房	Kitchen
LIV/DIN	客 / 飯廳	Living/Dining Room
P.D.	管槽	Pipe Duct
RS&MRR	垃圾及物料回收室	Refuse Storage and Material Recovery Room
W.M.C.	水錶櫃	Water Meter Cupboard
TELECOM AND ELV. RM.	電訊及特低壓電掣機房	Telecommunication and Extra-Low Voltage Cable Room
ELEC. METER RM.	電錶房	Electrical Meter Room

1. 每個住宅物業的層與層之間的高度為2.79米。
2. 每個住宅物業的樓板 (不包括灰泥) 的厚度為200 毫米。
3. 因住宅物業的較高樓層的結構牆的厚度遞減，較高樓層的內部面積，一般比較低樓層的內部面積稍大。(不適用於該發展項目)

1. The floor-to-floor height of each residential property is 2.79m.
2. The thickness of the floor slab (excluding plaster) of each residential property is 200mm.
3. The internal areas of the residential properties on the upper floors will generally be slightly larger than those on the lower floors because of the reducing thickness of the structural walls on the upper floors. (Not applicable to the Development)

註：平面圖所列之數字為以毫米標示之建築結構尺寸。

Note: The dimensions on the floor plan are all structural dimensions in millimetre.