



錦柏苑

Kam Pak Court

實用面積
SALEABLE AREA

43.7 平方米sq.m. (470平方呎 sq.ft.)

BLOCK 座	FLOOR 樓層	FLAT 室
A	2-20/F 和 22-43/F 2-20/F and 22-43/F	4

註：

1. 上述實用面積是按照《一手住宅物業銷售條例》第8條計算得出。
2. 上述以平方呎列明之面積是以1平方米=10.764平方呎換算，並四捨五入至整數平方呎。
3. 此平面圖是根據房屋局常任秘書長辦公室的獨立審查組最近期批准之建築圖則所編製。個別單位的間隔仍會改變，並會以最後獲批准之建築圖則為準。
4. 21樓為庇護層。

Notes:

1. The saleable areas as stated above are calculated in accordance with section 8 of the Residential Properties (First-hand Sales) Ordinance.
2. The areas as specified above in square feet are converted at a rate of 1 square metre = 10.764 square feet and rounded to the nearest whole square foot.
3. This Floor Plan is prepared in accordance with the latest building plan approved by the Independent Checking Unit of the Office of the Permanent Secretary for Housing. The layout of individual flats are subject to changes and the final building plans to be approved.
4. 21/F is the refuge floor.

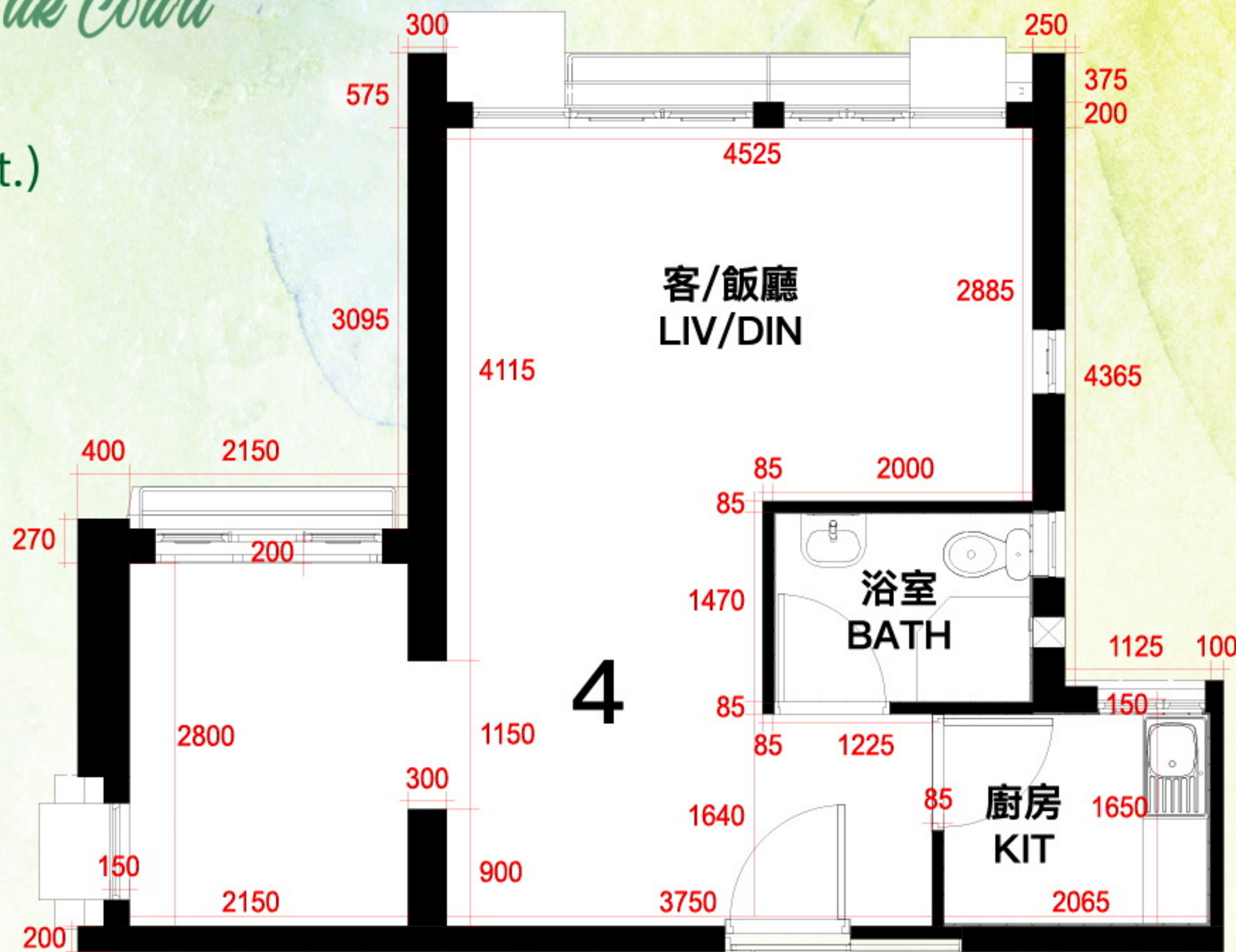

註：平面圖所列之數字為以毫米標示之建築結構尺寸。

Note: The dimensions on the floor plan are all structural dimensions in millimetre.