

發展項目的位置圖

Location Plan of the Development

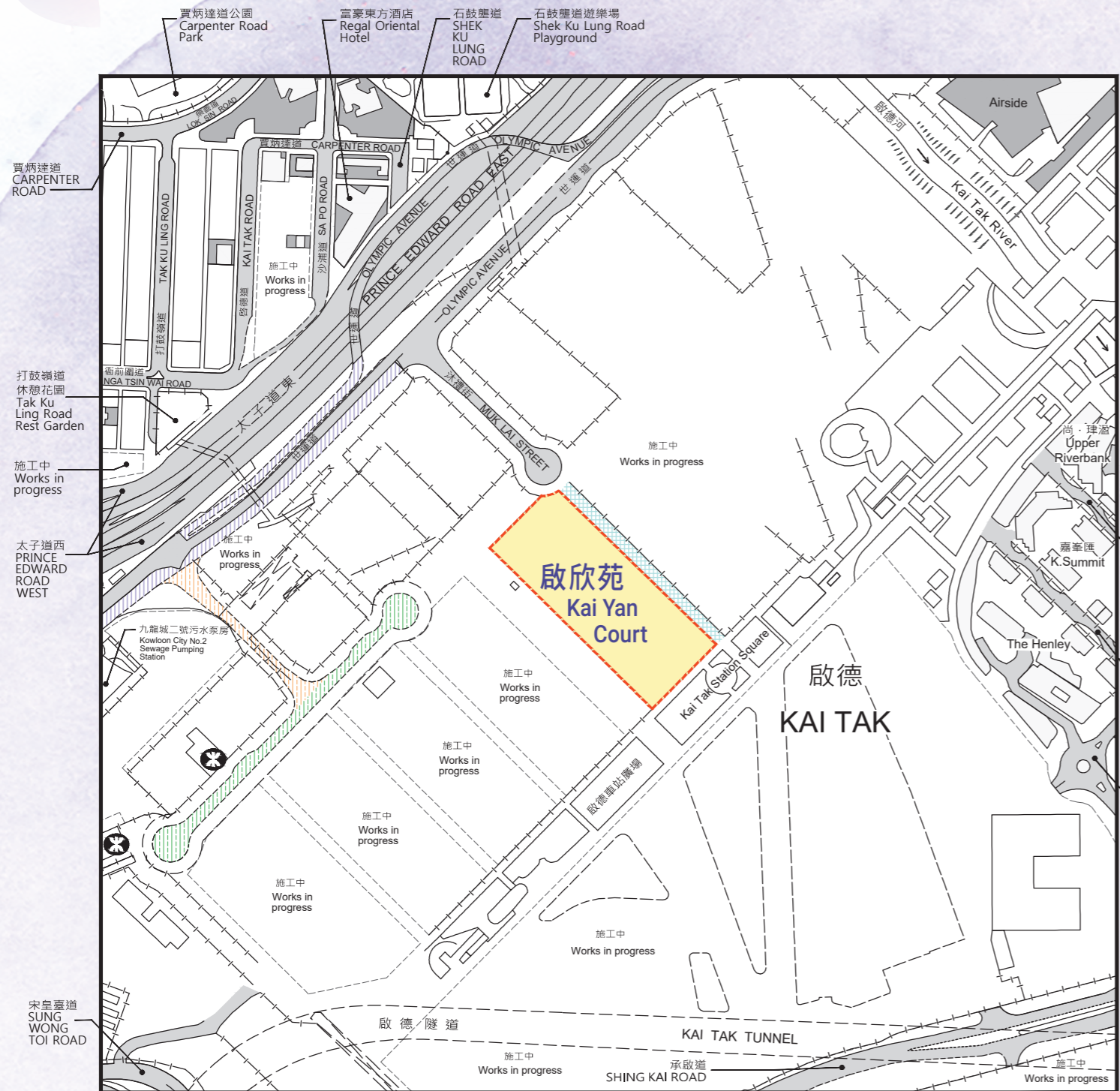

圖例 NOTATION

-  興建中的沐和街*
Muk Wo Street under Construction*
-  興建中的一段德高道*
Section of Dakota Drive under Construction*
-  興建中的一段世運道*
Section of Olympic Avenue under Construction*
-  行人專用街道
Pedestrian Street
-  宋皇臺站
Sung Wong Toi Station

*只作識別用
*For Identification Purposes Only

此位置圖是參考地政總署測繪處於2024年8月4日出版之數碼地形圖(編號分別為T11-NE-A及T11-NE-C)製作,有需要處經修正處理。

地圖由空間數據共享平台入門網站提供,香港特別行政區政府為知識產權擁有人。

The Location Plan is prepared with reference to the Digital Topographic Map Nos. T11-NE-A and T11-NE-C all dated 4 August 2024 from Survey and Mapping Office of the Lands Department, with adjustments where necessary.

The map is provided by the Common Spatial Data Infrastructure Portal and intellectual property rights are owned by the Government of the HKSAR.

註: 賣方建議買方到該發展項目作實地考察,以對該發展項目、其周邊地區環境及附近的公共設施有較佳的了解。

Note: The Vendor advises purchasers to conduct on-site visit for a better understanding of the Development, its surrounding environment and the public facilities nearby.

比例尺 SCALE: 0 50 100 150 200 250(米)
(m)

發展項目的布局圖

Layout Plan of the Development

沐禮街
MUK LAI STREET

行人專用街道 PEDESTRIAN STREET

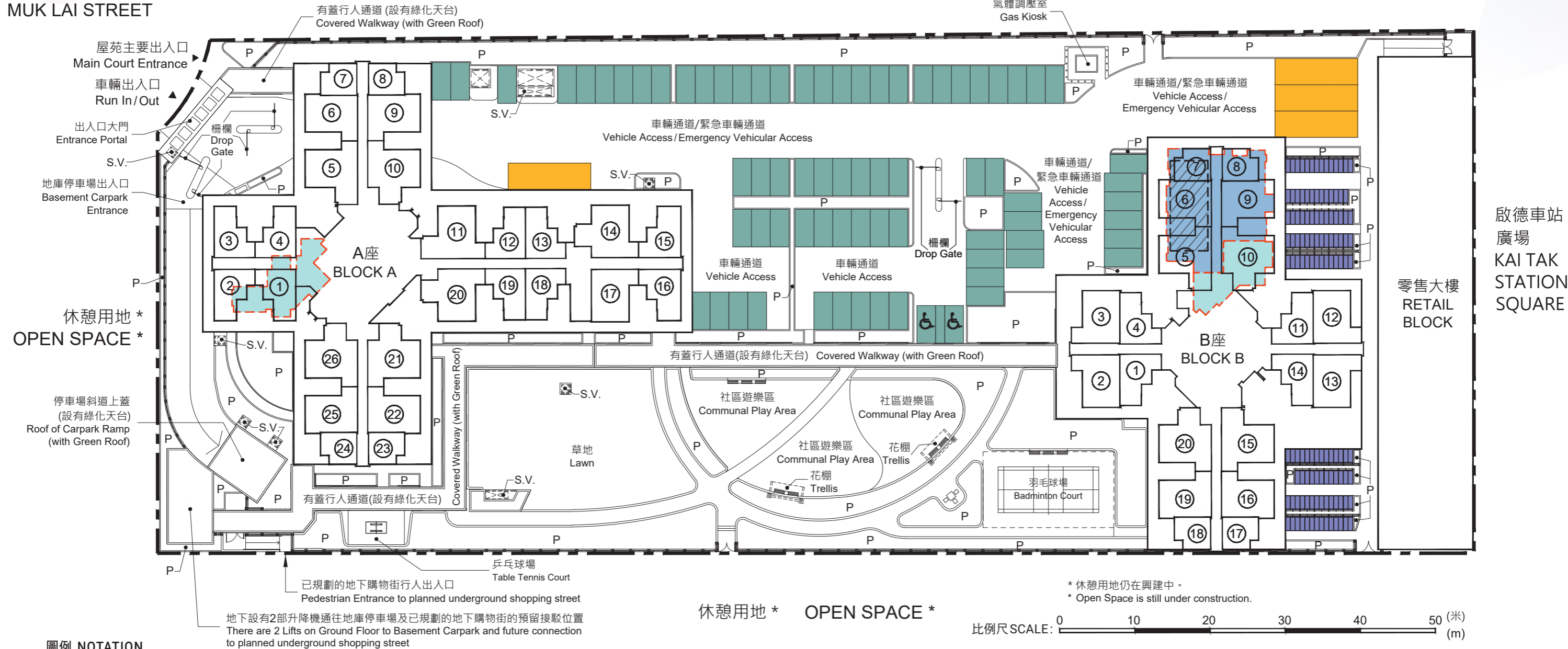

* 休憩用地仍在興建中。
* Open Space is still under construction.

圖例 NOTATION

圖例	描述	停車位類別	Category of Parking Space	數目 Number	備註
---	地界 Lot Boundary				
①	A座1樓-40樓單位室號 Block A Flat Number on 1/F-40/F B座1樓-40樓單位室號 Block B Flat Number on 1/F-40/F				
P	花槽 Planter				
S.V.	排煙口 Smoke Vent				
[Red dashed box]	地下垃圾及物料回收房 Refuse Storage and Material Recovery Chamber on Ground Floor	[Green box]	露天汽車停車位 Open Car Parking Spaces	72	發展項目於地庫另外設有64個有蓋汽車停車位、2個有蓋暢通易達汽車停車位及17個有蓋電單車停車位。 There are additional 64 numbers of covered Car Parking Spaces, 2 numbers of covered Accessible Car Parking Spaces and 17 numbers of covered Motorcycle Parking Spaces provided at the basement of the Development.
[Blue dashed box]	地下廢物收集站及垃圾存放處 Junk Collection Point and Refuse Storage on Ground Floor	[Green box with wheelchair symbol]	露天汽車停車位 (暢通易達汽車停車位) Open Car Parking Spaces (Accessible Car Parking Spaces)	2	
		[Yellow box]	露天上落客貨車位 Open Loading and Unloading Bays	4	
		[Blue box]	露天單車停車位 Open Bicycle Parking Spaces	123	
		[Blue hatched box]	有蓋垃圾車專用車位 Covered Loading and Unloading Space Reserved for Refuse Collection Vehicles	1	

座標準樓層平面圖 (2樓至40樓)

Block A Typical Floor Plan (2/F-40/F)

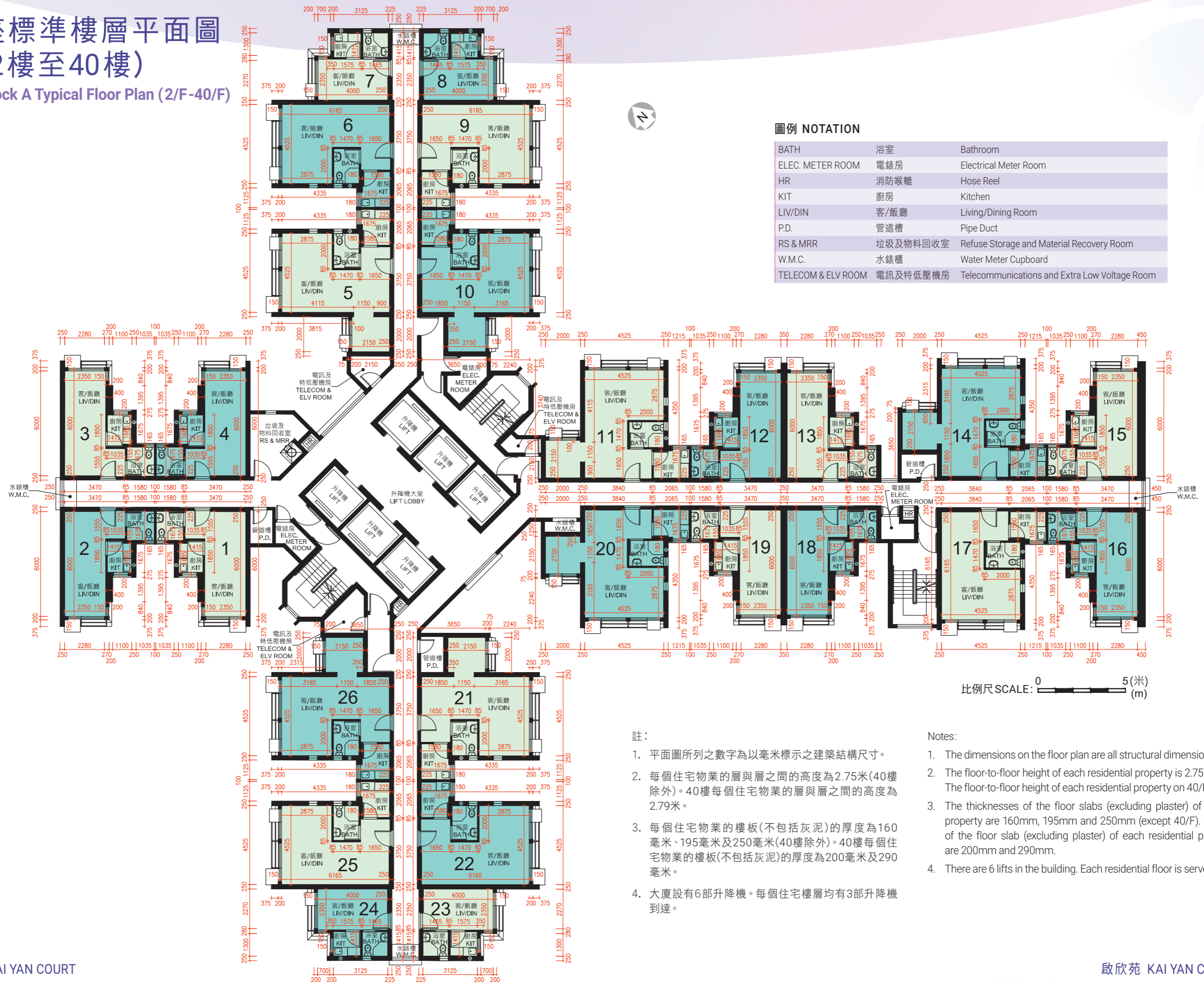

圖例 NOTATION

BATH	浴室	Bathroom
ELEC. METER ROOM	電錶房	Electrical Meter Room
HR	消防喉轆	Hose Reel
KIT	廚房	Kitchen
LIV/DIN	客/飯廳	Living/Dining Room
P.D.	管道槽	Pipe Duct
RS & MRR	垃圾及物料回收室	Refuse Storage and Material Recovery Room
W.M.C.	水錶櫃	Water Meter Cupboard
TELECOM & ELV ROOM	電訊及特低壓機房	Telecommunications and Extra Low Voltage Room

比例尺 SCALE: 0 5(米) (m)

註:

1. 平面圖所列之數字為以毫米標示之建築結構尺寸。
2. 每個住宅物業的層與層之間的高度為2.75米(40樓除外)。40樓每個住宅物業的層與層之間的高度為2.79米。
3. 每個住宅物業的樓板(不包括灰泥)的厚度為160毫米、195毫米及250毫米(40樓除外)。40樓每個住宅物業的樓板(不包括灰泥)的厚度為200毫米及290毫米。
4. 大廈設有6部升降機。每個住宅樓層均有3部升降機到達。

Notes:

1. The dimensions on the floor plan are all structural dimensions in millimetre.
2. The floor-to-floor height of each residential property is 2.75m (except 40/F). The floor-to-floor height of each residential property on 40/F is 2.79m.
3. The thicknesses of the floor slabs (excluding plaster) of each residential property are 160mm, 195mm and 250mm (except 40/F). The thicknesses of the floor slab (excluding plaster) of each residential property on 40/F are 200mm and 290mm.
4. There are 6 lifts in the building. Each residential floor is served by 3 lifts.



座標準樓層平面圖 (2樓至40樓)

Block B Typical Floor Plan (2/F-40/F)

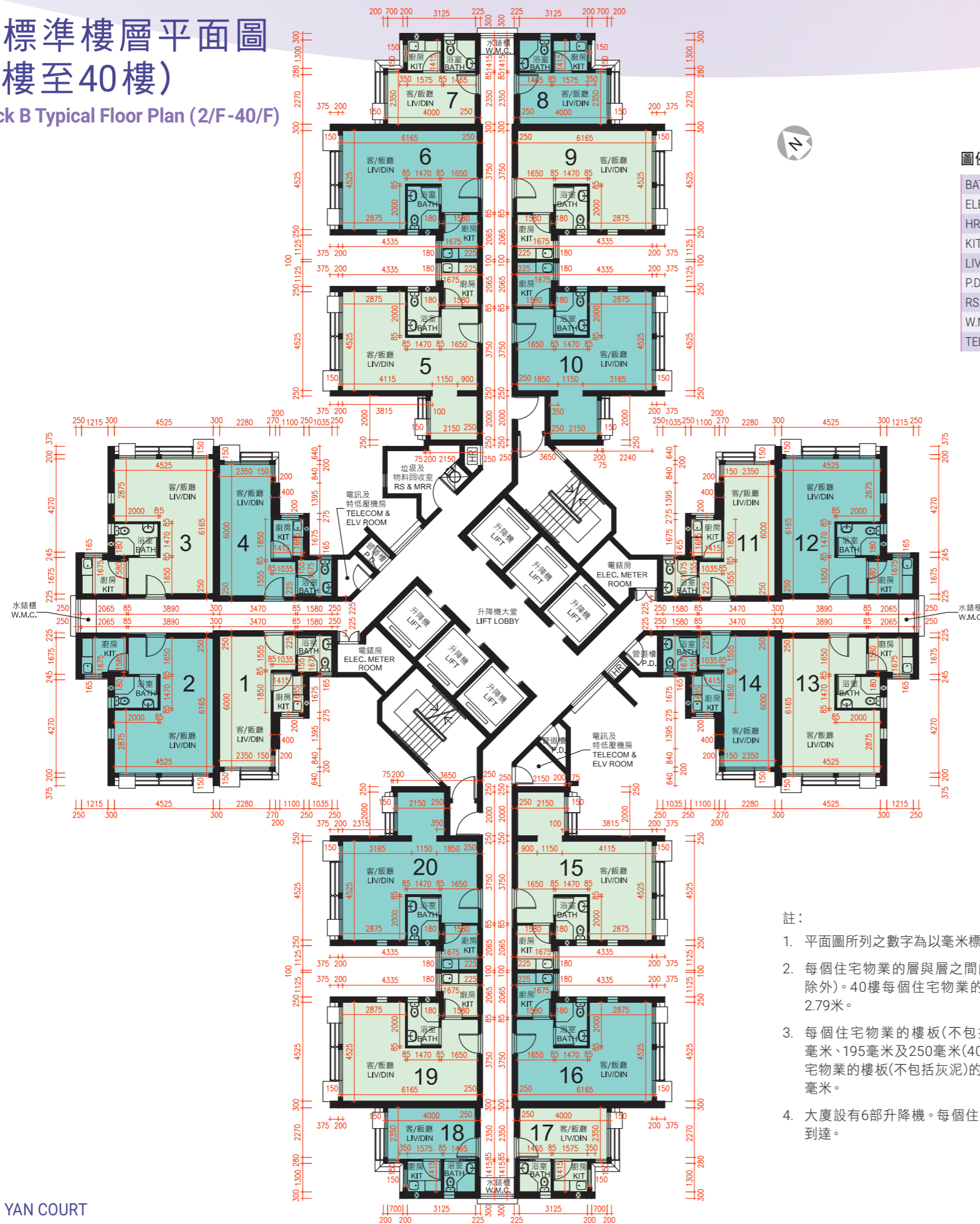

圖例 NOTATION

BATH	浴室	Bathroom
ELEC. METER ROOM	電錶房	Electrical Meter Room
HR	消防喉轆	Hose Reel
KIT	廚房	Kitchen
LIV/DIN	客/飯廳	Living/Dining Room
P.D.	管道槽	Pipe Duct
RS & MRR	垃圾及物料回收室	Refuse Storage and Material Recovery Room
W.M.C.	水錶櫃	Water Meter Cupboard
TELECOM & ELV ROOM	電訊及特低壓機房	Telecommunications and Extra Low Voltage Room

比例尺 SCALE: 0 5(米)
(m)

註:

1. 平面圖所列之數字為以毫米標示之建築結構尺寸。
2. 每個住宅物業的層與層之間的高度為2.75米(40樓除外)。40樓每個住宅物業的層與層之間的高度為2.79米。
3. 每個住宅物業的樓板(不包括灰泥)的厚度為160毫米、195毫米及250毫米(40樓除外)。40樓每個住宅物業的樓板(不包括灰泥)的厚度為200毫米及290毫米。
4. 大廈設有6部升降機。每個住宅樓層均有3部升降機到達。

Notes:

1. The dimensions on the floor plan are all structural dimensions in millimetre.
2. The floor-to-floor height of each residential property is 2.75m (except 40/F). The floor-to-floor height of each residential property on 40/F is 2.79m.
3. The thicknesses of the floor slabs (excluding plaster) of each residential property are 160mm, 195mm and 250mm (except 40/F). The thicknesses of the floor slab (excluding plaster) of each residential property on 40/F are 200mm and 290mm.
4. There are 6 lifts in the building. Each residential floor is served by 3 lifts.

