

發展項目的位置圖

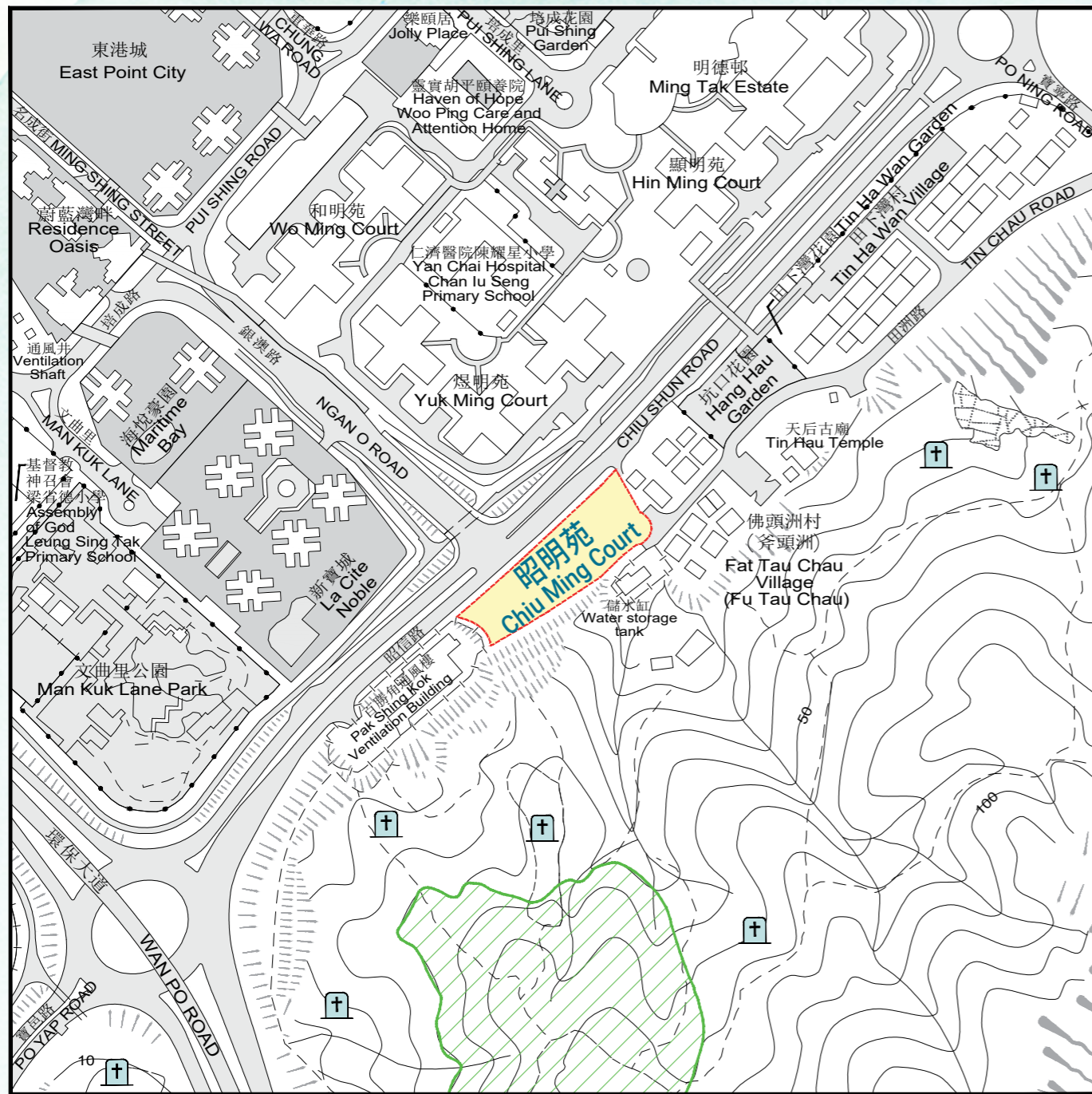

Location Plan of the Development



比例尺 SCALE: 0 50 100 150 200 250 (米)
(m)



圖例 NOTATION

-  認可殯葬區*
Permitted Burial Ground*
-  斜坡上有零散山墳*
Slope with Scattered Graves*

* 只作識別用
* For Identification Purposes Only

此位置圖是參考地政總署測繪處於2026年2月12日出版之數碼地形圖(編號為T12-NW-C)製作，有需要處經修正處理。
地圖由空間數據共享平台入門網站提供，香港特別行政區政府為知識產權擁有人。

The Location Plan is prepared with reference to the Digital Topographic Map No. T12-NW-C dated 12 February 2026 from Survey and Mapping Office of the Lands Department, with adjustments where necessary.

The map is provided by the Common Spatial Data Infrastructure Portal and intellectual property rights are owned by the Government of the HKSAR.

註：賣方建議買方到該發展項目作實地考察，以對該發展項目、其周邊地區環境及附近的公共設施有較佳的了解。

Note: The Vendor advises purchasers to conduct on-site visit for a better understanding of the Development, its surrounding environment and the public facilities nearby.

昭信路 Chiu Shun Road

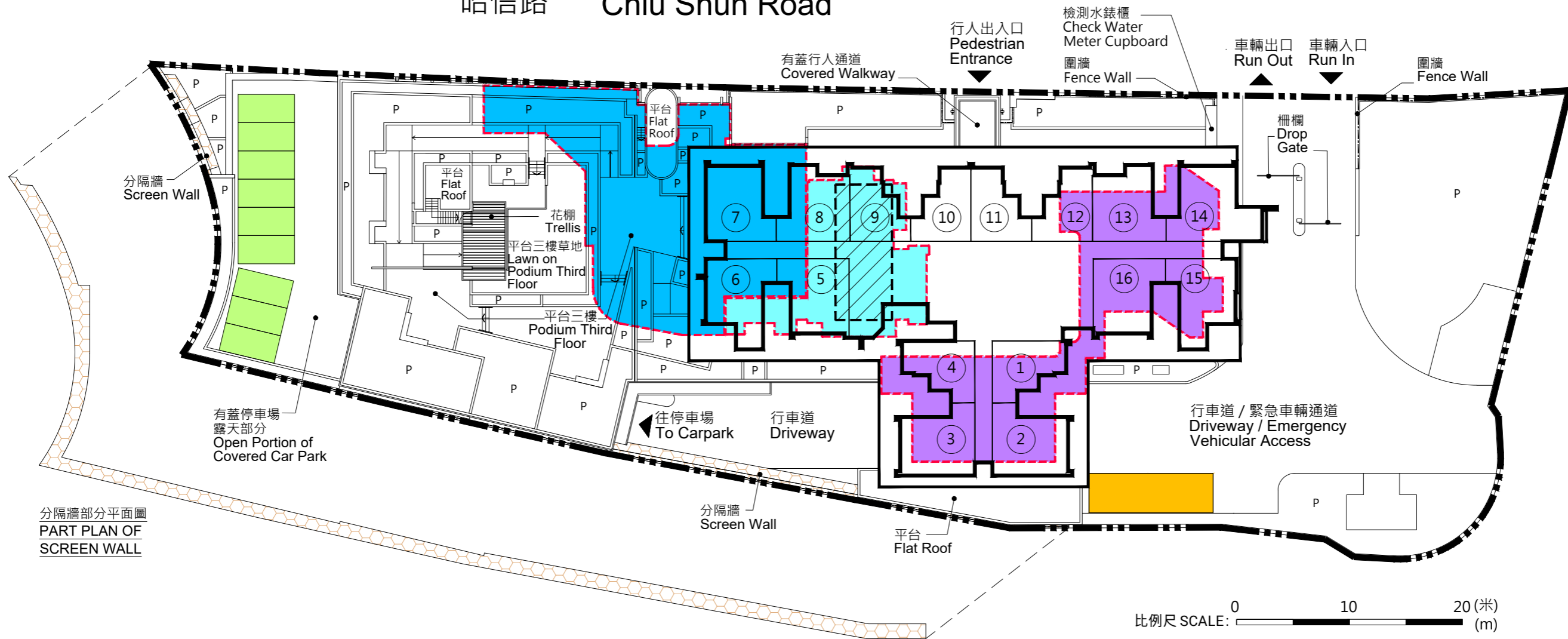

分隔牆部分平面圖
PART PLAN OF
SCREEN WALL

圖例 NOTATION

		停車位類別 Category of Parking Space	數目 Number	
	地界 Lot Boundary		露天汽車停車位 Open Car Parking Spaces	9
	4樓至41樓單位室號 (35樓至41樓不設5號及16號單位) Flat Number on 4/F - 41/F (No Provision of Flat 5 and Flat 16 for 35/F - 41/F)		露天上落客貨停車位 Open Loading/Unloading Bay	1
P	花槽 Planter		有蓋垃圾車專用車位 Covered Loading/Unloading Space Reserved for Refuse Collection Vehicle	1
	地下長者鄰舍中心 Neighbourhood Elderly Centre on Ground Floor			
	地下廢物收集站、垃圾及物料回收房 Junk Collection Point, Refuse Storage and Material Recovery Chamber on Ground Floor			
	平台三樓有蓋公用遊樂區 Covered Communal Play Area on Podium Third Floor			
	分隔牆 Screen Wall			

發展項目另設有51個有蓋汽車停車位，2個有蓋暢通易達停車位及6個有蓋電單車停車位。
There are also 51 covered Car Parking Spaces, 2 covered Accessible Car Parking Spaces and 6 covered Motorcycle Parking Spaces provided of the Development.

標準樓層平面圖 (5樓至34樓)

Typical Floor Plan (5/F-34/F)



圖例 NOTATION

BATH	浴室	Bathroom
ELEC. METER ROOM	電錶房	Electrical Meter Room
HR	消防喉轆	Hose Reel
KIT	廚房	Kitchen
LIV/DIN	客/飯廳	Living/Dining Room
RS & MRR	垃圾及物料回收室	Refuse Storage and Material Recovery Room
TELECOM ROOM	電訊機房	Telecommunications Room
W.M.C.	水錶櫃	Water Meter Cupboard
P.D.	管道槽	Pipe Duct
	減音窗	Acoustic Window
	固定窗	Fixed Window

註：

1. 平面圖所列之數字為以毫米標示之建築結構尺寸。
2. 每個住宅物業的層與層之間的高度為2.75米(34樓5號及16號單位除外)。
34樓5號及16號單位的層與層之間的高度為2.79米。
3. 每個住宅物業的樓板(不包括灰泥)的厚度為160毫米及215毫米(34樓5號及16號單位除外)。
34樓5號及16號單位的樓板(不包括灰泥)的厚度為200毫米。
4. 大廈設有4部升降機。每個住宅樓層均有4部升降機到達。
5. 為減低道路交通噪音的影響,部分單位設有減音窗及固定窗。
6. 此標準樓層平面圖是根據揀選一張可顯示每層最多住宅單位的圖則而選定。其他位於其餘樓層的住宅單位平面圖,請參閱將選購單位日期前提供的售樓說明書。

Notes:

1. The dimensions on the floor plan are all structural dimensions in millimetre.
2. The floor-to-floor height of each residential property is 2.75m (except flat 5 and flat 16 on 34/F).
The floor-to-floor height of flat 5 and flat 16 on 34/F is 2.79m.
3. The thicknesses of the floor slabs (excluding plaster) of each residential property are 160mm and 215mm (except flat 5 and flat 16 on 34/F).
The thickness of the floor slab (excluding plaster) of flat 5 and flat 16 on 34/F is 200mm.
4. There are 4 lifts in the building. Each residential floor is served by 4 lifts.
5. In order to mitigate the impact of road traffic noise, acoustic windows and fixed windows are provided in some flats.
6. This Typical Floor Plan is selected on the basis of selecting one floor plan which shows the most number of residential flats per floor. For floor plans of other residential flats on the remaining floors, please refer to the sales brochure which will be available before the date of flat selection.

比例尺 SCALE: 5 (米) (m)

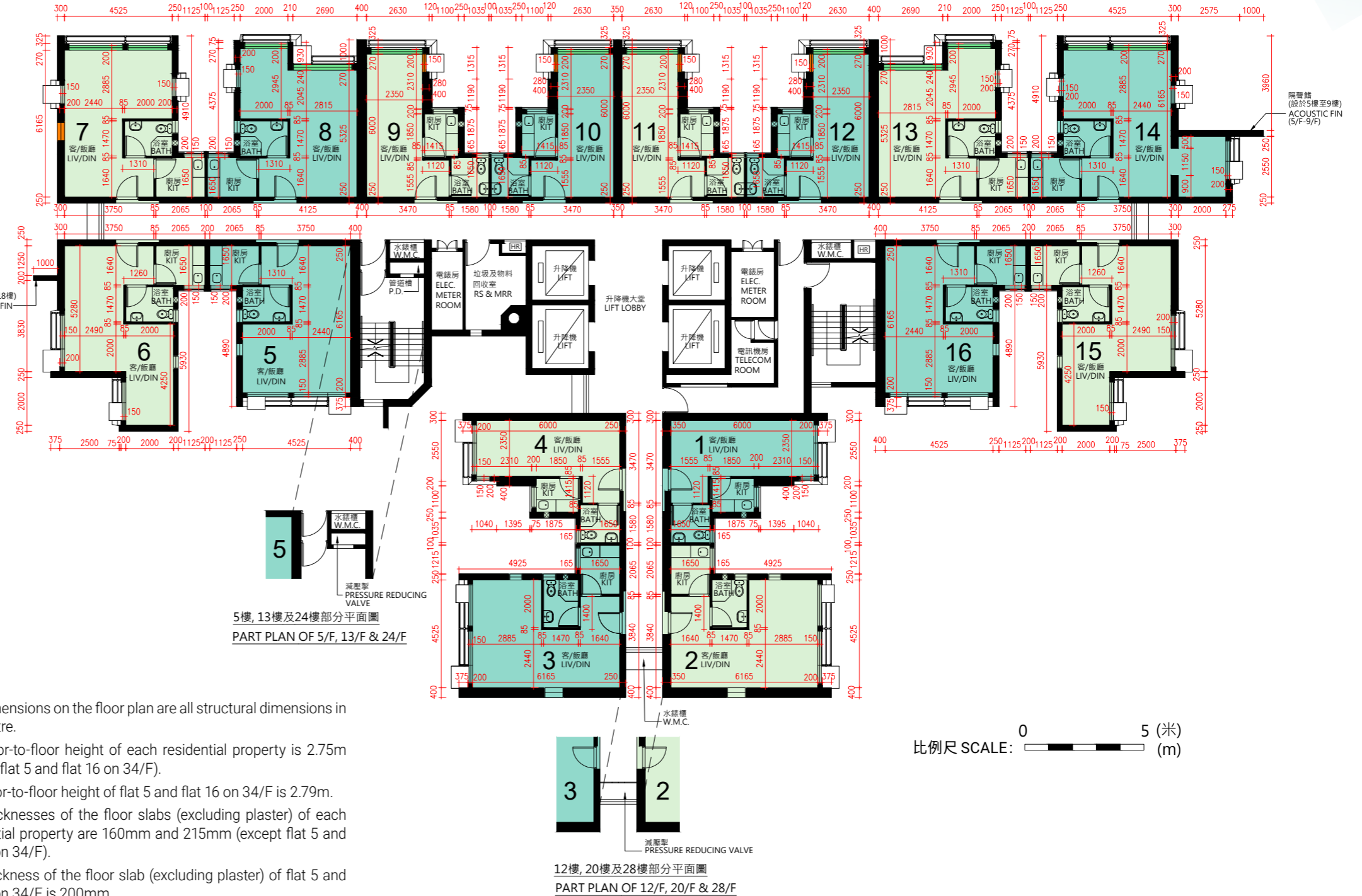

5樓, 13樓及24樓部分平面圖
PART PLAN OF 5/F, 13/F & 24/F

12樓, 20樓及28樓部分平面圖
PART PLAN OF 12/F, 20/F & 28/F