

發展項目的位置圖

Location Plan of the Development

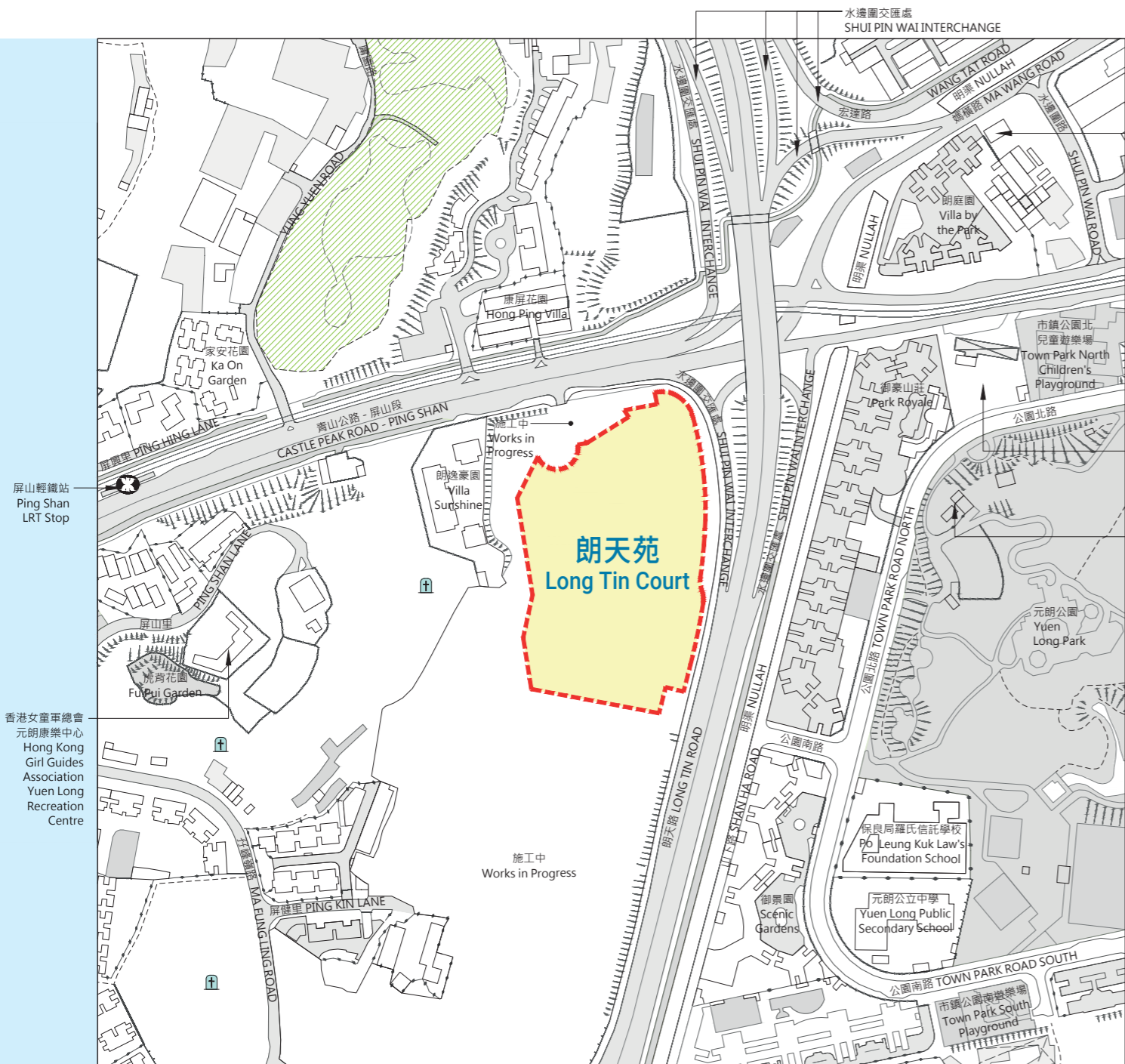

水邊圍洪水泵房
Shui Pin Wai
Floodwater
Pumping Station

圖例 NOTATION

認可殯葬區*
Permitted Burial Ground*

零散山墳所在斜坡*
Slope with Scattered Graves*

* 只作識別用

* For Identification Purposes Only

博愛醫院元朗商會極限運動場
Pok Oi Hospital Yuen Long
Merchants Association
Extreme Sports Park

香港女童軍總會元朗西區區總部
Scout Association of Hong
Kong Yuen Long West
District Headquarters

此位置圖是參考地政總署測繪處於2026年1月29日出版之數碼地形圖(編號為T6-NW-B)製作,有需要處經修正處理。

地圖由空間數據共享平台入門網站提供,香港特別行政區政府為知識產權擁有人。

The Location Plan is prepared with reference to the Digital Topographic Map No. T6-NW-B dated 29 January 2026 from Survey and Mapping Office of the Lands Department, with adjustments where necessary.

The map is provided by the Common Spatial Data Infrastructure Portal and intellectual property rights are owned by the Government of the HKSAR.

註: 賣方建議買方到該發展項目作實地考察,以對該發展項目、其周邊地區環境及附近的公共設施有較佳的了解。

Note: The Vendor advises purchasers to conduct on-site visit for a better understanding of the Development, its surrounding environment and the public facilities nearby.

比例尺 SCALE: 0 50 100 150 200 250 (米)
(m)

發展項目的布局圖

Layout Plan of the Development

圖例 NOTATION

- 地界 Lot Boundary
- ① A座3樓-23樓及25樓-47樓單位室號 (39樓-47樓不設7號-10號單位)
Block A Flat Number on 3/F to 23/F and 25/F to 47/F (No provision of Flat 7 to Flat 10 for 39/F to 47/F)
- B座1樓-24樓及26樓-49樓單位室號 (1樓不設9號-12號單位)
Block B Flat Number on 1/F to 24/F and 26/F to 49/F (No provision of Flat 9 to Flat 12 for 1/F)
- C座1樓-24樓及26樓-49樓單位室號 (1樓不設5號-8號單位)
Block C Flat Number on 1/F to 24/F and 26/F to 49/F (No provision of Flat 5 to Flat 8 for 1/F)
- P 花槽 Planter
- 地下幼稚園 Kindergarten on Ground Floor
- 地下有蓋兒童遊樂區/有蓋園景及遊樂區 Covered Children's Play Area / Covered Landscaped and Play Area on Ground Floor
- 平台1樓長者鄰舍中心 Neighbourhood Elderly Centre on Podium Level 1
- 平台1樓綜合青少年服務中心 Integrated Children and Youth Services Centre on Podium Level 1
- 平台2樓有蓋園景及遊樂區 Covered Landscaped and Play Area on Podium Level 2
- 1樓有蓋兒童遊樂區/有蓋園景及遊樂區 Covered Children's Play Area / Covered Landscaped and Play Area on First Floor
- 地下垃圾及物料回收房 Refuse Storage and Material Recovery Chamber on Ground Floor
- 總水錶房 MASTER WATER METER ROOM
- 花棚 Trellis

停車位類別 Category of Parking Space 數目 Number

- 地下露天上下落客貨停車位 2
Open Loading and Unloading Bays on Ground Floor
- 地下部分有蓋上下落客貨停車位 1
Partially Covered Loading and Unloading Bay on Ground Floor
- 地下有蓋上下落客貨停車位 (供商業設施) 2
Covered Loading and Unloading Bays on Ground Floor (for commercial facilities)
- 地下露天單車停車位 411
Open Bicycle Parking Spaces on Ground Floor
- 地下有蓋垃圾收集車專用車位 1
Covered Loading and Unloading Space Reserved for Refuse Collection Vehicle on Ground Floor

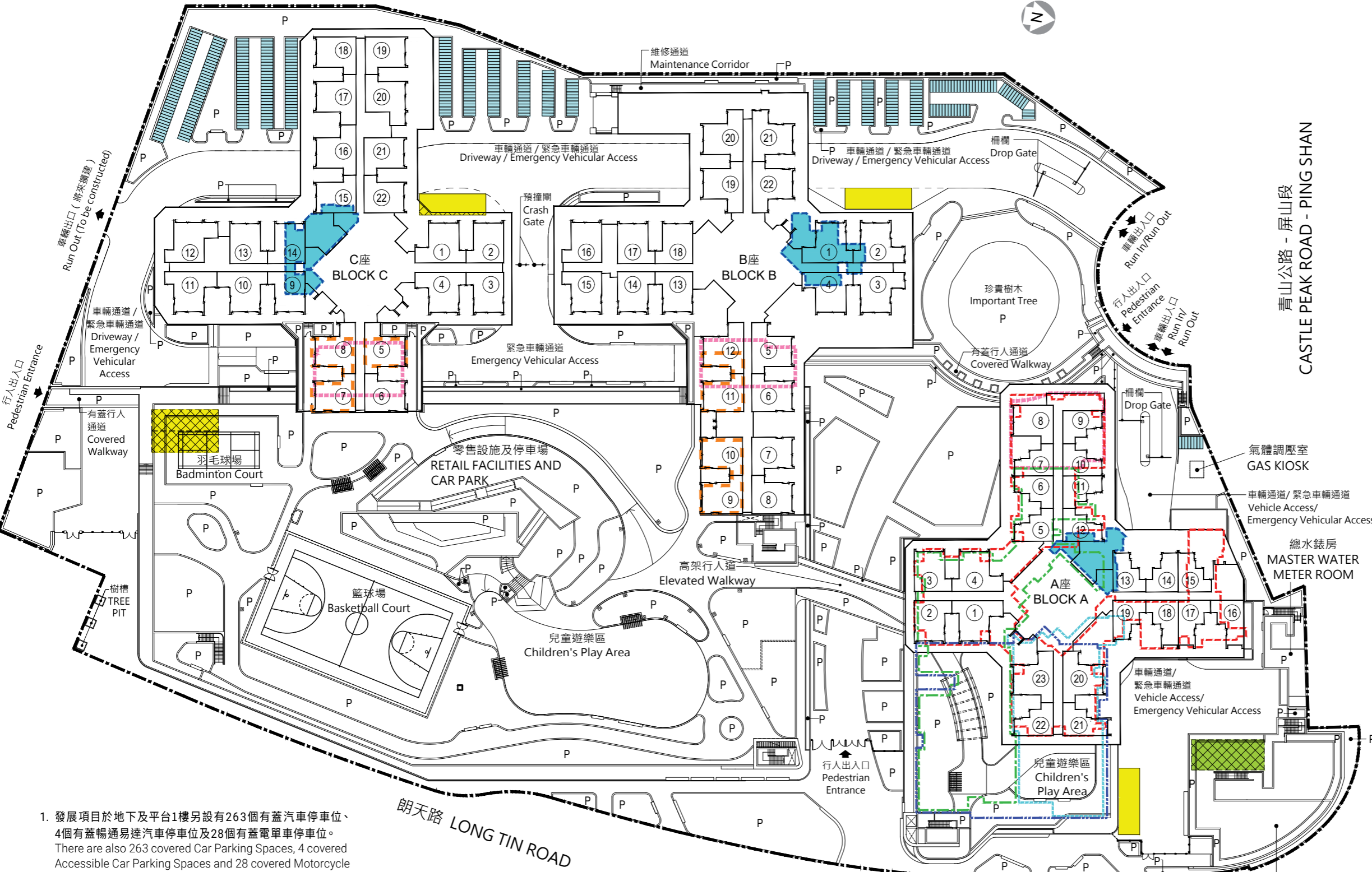

1. 發展項目於地下及平台1樓另設有263個有蓋汽車停車位、4個有蓋暢通易達汽車停車位及28個有蓋電單車停車位。
There are also 263 covered Car Parking Spaces, 4 covered Accessible Car Parking Spaces and 28 covered Motorcycle Parking Spaces provided on Ground Floor and Podium Level 1 of the Development.
2. 發展項目於零售設施及停車場的地下設有商業設施。
There are commercial facilities provided on Ground Floor of the Retail Facilities and Car Park of the Development.

座標準樓層平面圖 (4樓至38樓，24樓除外)

Block A Typical Floor Plan (4/F-38/F, except 24/F)

註：

1. 平面圖所列之數字為以毫米標示之建築結構尺寸。
2. 每個住宅物業的層與層之間的高度為2.75米(23樓的1號至23號單位及38樓的7號至10號單位除外)。
23樓的1號至23號單位及38樓的7號至10號單位每個住宅物業的層與層之間的高度為2.79米。
3. 4樓至22樓及25樓至37樓每個住宅物業的樓板(不包括灰泥)的厚度為160毫米、195毫米及250毫米(16號至18號及21號單位除外)。
4樓至22樓及25樓至37樓的16號至18號及21號單位每個住宅物業的樓板(不包括灰泥)的厚度為130毫米、160毫米、195毫米及250毫米。
23樓每個住宅物業的樓板(不包括灰泥)的厚度為200毫米及290毫米(16號至18號及21號單位除外)。
23樓的16號至18號及21號單位每個住宅物業的樓板(不包括灰泥)的厚度為200毫米、290毫米及450毫米。
38樓每個住宅物業的樓板(不包括灰泥)的厚度為160毫米、195毫米及250毫米(7號至10號、16號至18號及21號單位除外)。
38樓的7號至10號單位每個住宅物業的樓板(不包括灰泥)的厚度為200毫米及290毫米。
38樓的16號至18號及21號單位每個住宅物業的樓板(不包括灰泥)的厚度為130毫米、160毫米、195毫米及250毫米。
4. 大廈設有8部升降機。每個住宅樓層均有4部升降機到達。
5. 庇護層位於24樓。
6. 為減低道路交通噪音的影響，部分單位設有減音露台、減音窗及 / 或固定窗。
7. 此標準樓層平面圖是根據揀選一張可顯示每層最多住宅單位的圖則而選定。其他位於其餘樓層的住宅單位平面圖，請參閱將在選購單位日期前提供的售樓說明書。

Notes:

1. The dimensions on the floor plan are all structural dimensions in millimetre.
2. The floor-to-floor height of each residential property is 2.75m (except Flat 1 to 23 on 23/F and Flat 7 to 10 on 38/F).
The floor-to-floor height of each residential property of Flat 1 to 23 on 23/F and Flat 7 to 10 on 38/F is 2.79m.
3. The thicknesses of the floor slabs (excluding plaster) of each residential property on 4/F to 22/F and 25/F to 37/F are 160mm, 195mm and 250mm (except Flat 16 to 18 and 21).
The thicknesses of the floor slabs (excluding plaster) of each residential property of Flat 16 to 18 and 21 on 4/F to 22/F and 25/F to 37/F are 130mm, 160mm, 195mm and 250mm.
The thicknesses of the floor slabs (excluding plaster) of each residential property on 23/F are 200mm and 290mm (except Flat 16 to 18 and 21).
The thicknesses of the floor slabs (excluding plaster) of each residential property of Flat 16 to 18 and 21 on 23/F are 200mm, 290mm and 450mm.
The thicknesses of the floor slabs (excluding plaster) of each residential property on 38/F are 160mm, 195mm and 250mm (except Flat 7 to 10, 16 to 18 and 21).
The thicknesses of the floor slabs (excluding plaster) of each residential property of Flat 7 to 10 on 38/F are 200mm and 290mm.
The thicknesses of the floor slabs (excluding plaster) of each residential property of Flat 16 to 18 and 21 on 38/F are 130mm, 160mm, 195mm and 250mm.
4. There are 8 lifts in the building. Each residential floor is served by 4 lifts.
5. Refuge floor is located at 24/F.
6. In order to mitigate the impact of road traffic noise, acoustic balconies, acoustic windows and / or fixed windows are provided for some flats.
7. This Typical Floor Plan is selected on the basis of selecting one floor plan which shows the most number of residential flats per floor. For floor plans of other residential flats on the remaining floors, please refer to the sales brochure which will be available before the date of flat selection.

朗天苑 LONG TIN COURT



B 座標準樓層平面圖 (2樓至49樓，25樓除外)

Block B Typical Floor Plan (2/F-49/F, except 25/F)

註：

1. 平面圖所列之數字為以毫米標示之建築結構尺寸。
2. 每個住宅物業的層與層之間的高度為2.75米(24樓及49樓除外)。
24樓及49樓每個住宅物業的層與層之間的高度為2.79米。
3. 每個住宅物業的樓板(不包括灰泥)的厚度為160毫米、195毫米及250毫米(24樓及49樓除外)。
24樓及49樓每個住宅物業的樓板(不包括灰泥)的厚度為200毫米及290毫米。
4. 大廈設有9部升降機。每個住宅樓層均有3部升降機到達。
5. 庇護層位於25樓。
6. 為減低道路交通噪音的影響，部分單位設有減音窗及/或固定窗。
7. 此標準樓層平面圖是根據揀選一張可顯示每層最多住宅單位的圖則而選定。其他位於其餘樓層的住宅單位平面圖，請參閱將在選購單位日期前提供的售樓說明書。

Notes:

1. The dimensions on the floor plan are all structural dimensions in millimetre.
2. The floor-to-floor height of each residential property is 2.75m (except 24/F and 49/F).
The floor-to-floor height of each residential property on 24/F and 49/F is 2.79m.
3. The thicknesses of the floor slabs (excluding plaster) of each residential property are 160mm, 195mm and 250mm (except 24/F and 49/F).
The thicknesses of the floor slabs (excluding plaster) of each residential property on 24/F and 49/F are 200mm and 290mm.
4. There are 9 lifts in the building. Each residential floor is served by 3 lifts.
5. Refuge floor is located at 25/F.
6. In order to mitigate the impact of road traffic noise, acoustic windows and / or fixed windows are provided for some flats.
7. This Typical Floor Plan is selected on the basis of selecting one floor plan which shows the most number of residential flats per floor. For floor plans of other residential flats on the remaining floors, please refer to the sales brochure which will be available before the date of flat selection.



圖例 NOTATION

BATH	浴室	Bathroom
ELEC. METER ROOM	電錶房	Electrical Meter Room
HR	消防喉嚨	Hose Reel
KIT	廚房	Kitchen
LIV/DIN	客/飯廳	Living/Dining Room
P.D.	管道槽	Pipe Duct
RS & MRR	垃圾及物料回收室	Refuse Storage and Material Recovery Room
TELECOM AND ELV ROOM	電訊及特低壓機房	Telecommunications and Extra Low Voltage Room
W.M.C.	水錶櫃	Water Meter Cupboard
	減音窗	Acoustic Window
	固定窗	Fixed Window

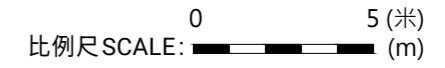

朗天苑 LONG TIN COURT
印製日期: 2026年3月3日
Date of Printing: 3 March 2026

座標準樓層平面圖 (2樓至49樓，25樓除外)

Block C Typical Floor Plan (2/F-49/F, except 25/F)

註：

1. 平面圖所列之數字為以毫米標示之建築結構尺寸。
2. 每個住宅物業的層與層之間的高度為2.75米(24樓及49樓除外)。
24樓及49樓每個住宅物業的層與層之間的高度為2.79米。
3. 每個住宅物業的樓板(不包括灰泥)的厚度為160毫米、195毫米及250毫米(24樓及49樓除外)。
24樓及49樓每個住宅物業的樓板(不包括灰泥)的厚度為200毫米及290毫米。
4. 大廈設有9部升降機。每個住宅樓層均有3部升降機到達。
5. 庇護層位於25樓。
6. 為減低道路交通噪音的影響，部分單位設有減音窗及/或固定窗。
7. 此標準樓層平面圖是根據揀選一張可顯示每層最多住宅單位的圖則而選定。其他位於其餘樓層的住宅單位平面圖，請參閱將在選購單位日期前提供的售樓說明書。

Notes:

1. The dimensions on the floor plan are all structural dimensions in millimetre.
2. The floor-to-floor height of each residential property is 2.75m (except 24/F and 49/F).
The floor-to-floor height of each residential property on 24/F and 49/F is 2.79m.
3. The thicknesses of the floor slabs (excluding plaster) of each residential property are 160mm, 195mm and 250mm (except 24/F and 49/F).
The thicknesses of the floor slabs (excluding plaster) of each residential property on 24/F and 49/F are 200mm and 290mm.
4. There are 9 lifts in the building. Each residential floor is served by 3 lifts.
5. Refuge floor is located at 25/F.
6. In order to mitigate the impact of road traffic noise, acoustic windows and / or fixed windows are provided for some flats.
7. This Typical Floor Plan is selected on the basis of selecting one floor plan which shows the most number of residential flats per floor. For floor plans of other residential flats on the remaining floors, please refer to the sales brochure which will be available before the date of flat selection.

