

發展項目的位置圖

Location Plan of the Development



此位置圖是參考地政總署測繪處於2026年2月12日出版之數碼地形圖(編號分別為T11-NE-B及T11-NE-D)製作，有需要處經修正處理。地圖由空間數據共享平台入門網站提供，香港特別行政區政府為知識產權擁有人。

The Location Plan is prepared with reference to the Digital Topographic Map Nos. T11-NE-B and T11-NE-D all dated 12 February 2026 from Survey and Mapping Office of the Lands Department, with adjustments where necessary.

The map is provided by the Common Spatial Data Infrastructure Portal and intellectual property rights are owned by the Government of the HKSAR.

註：賣方建議買方到該發展項目作實地考察，以對該發展項目、其周邊地區環境及附近的公共設施有較佳的了解。

Note: The Vendor advises purchasers to conduct on-site visit for a better understanding of the Development, its surrounding environment and the public facilities nearby.

比例尺 SCALE: 0 50 100 150 200 250 (米) (m)

發展項目的布局圖

Layout Plan of the Development



比例尺 SCALE: 0 10 20 30 40 (米) (m)

圖例 NOTATION

- 地界
Lot Boundary
- 1 A座1樓至28樓單位室號
(1樓不設1號至10號單位)
Block A Flat Number on 1/F-28/F
(No provision of Flat 1-Flat 10 for 1/F)
B座1樓至28樓單位室號
(1樓不設5號至10號及12號至13號單位)
Block B Flat Number on 1/F-28/F
(No provision of Flat 5-Flat 10 & Flat 12-Flat 13 for 1/F)
- P 花槽
Planter
- CPA 兒童遊樂區
Children's Play Area
- T 花棚
Trellis
- 地下垃圾及物料回收房
Refuse Storage and Material Recovery Chamber on Ground Floor
- 地下垃圾及物料回收房、垃圾收集站及廢物收集站
Refuse Storage and Material Recovery Chamber, Refuse Collection Point and Junk Collection Point on Ground Floor

停車位類別 Category of Parking Space 數目 Number

- 地下露天上下落客貨停車位
Open Loading and Unloading Bays on Ground Floor 2
- 地下部分有蓋上下落客貨停車位
Partially Covered Loading and Unloading Bays on Ground Floor 2
- 地下有蓋垃圾車專用停車位
Covered Parking Space for Refuse Collection Vehicle on Ground Floor 1
- 地下露天單車停車位
Open Bicycle Parking Spaces on Ground Floor 66

發展項目於地下另外設有121個有蓋汽車停車位、2個有蓋暢通易達汽車停車位、4個有蓋輕型貨車停車位及9個有蓋電單車停車位。
There are also 121 numbers of covered Car Parking Spaces, 2 numbers of covered Accessible Car Parking Spaces, 4 numbers of covered Light Goods Vehicle Parking Spaces and 9 numbers of covered Motorcycle Parking Spaces provided on Ground Floor of the Development.

座標準樓層平面圖 (3樓至28樓)

Block A Typical Floor Plan (3/F-28/F)

圖例 NOTATION

| | | |
|----------------------|----------|---|
| BATH | 浴室 | Bathroom |
| ELEC. METER ROOM | 電錶房 | Electrical Meter Room |
| HR | 消防喉轆 | Hose Reel |
| KIT | 廚房 | Kitchen |
| LIV/DIN | 客/飯廳 | Living/Dining Room |
| P.D. | 管道槽 | Pipe Duct |
| RS & MRR | 垃圾及物料回收室 | Refuse Storage and Material Recovery Room |
| TELECOM AND ELV ROOM | 電訊及特低壓機房 | Telecommunications and Extra Low Voltage Room |
| W.M.C. | 水錶櫃 | Water Meter Cupboard |

註：

1. 平面圖所列之數字為以毫米標示之建築結構尺寸。
2. 每個住宅物業的層與層之間的高度為2.75米 (28樓除外)。
28樓每個住宅物業的層與層之間的高度為2.79米。
3. 每個住宅物業的樓板 (不包括灰泥) 的厚度為160毫米、195毫米及250毫米 (28樓除外)。
28樓每個住宅物業的樓板 (不包括灰泥) 的厚度為200毫米。
4. 大廈設有4部升降機。每個住宅樓層均有2部升降機到達。
5. 此標準樓層平面圖是根據揀選一張可顯示每層最多住宅單位的圖則而選定。其他位於其餘樓層的住宅單位平面圖，請參閱將在選購單位日期前提供的售樓說明書。

Notes:

1. The dimensions on the floor plan are all structural dimensions in millimetre.
2. The floor-to-floor height of each residential property is 2.75m (except 28/F).
The floor-to-floor height of each residential property on 28/F is 2.79m.
3. The thicknesses of the floor slabs (excluding plaster) of each residential property are 160mm, 195mm and 250mm (except 28/F).
The thickness of the floor slab (excluding plaster) of each residential property on 28/F is 200 mm.
4. There are 4 lifts in the building. Each residential floor is served by 2 lifts.
5. This Typical Floor Plan is selected on the basis of selecting one floor plan which shows the most number of residential flats per floor. For floor plans of other residential flats on the remaining floors, please refer to the sales brochure which will be available before the date of flat selection.

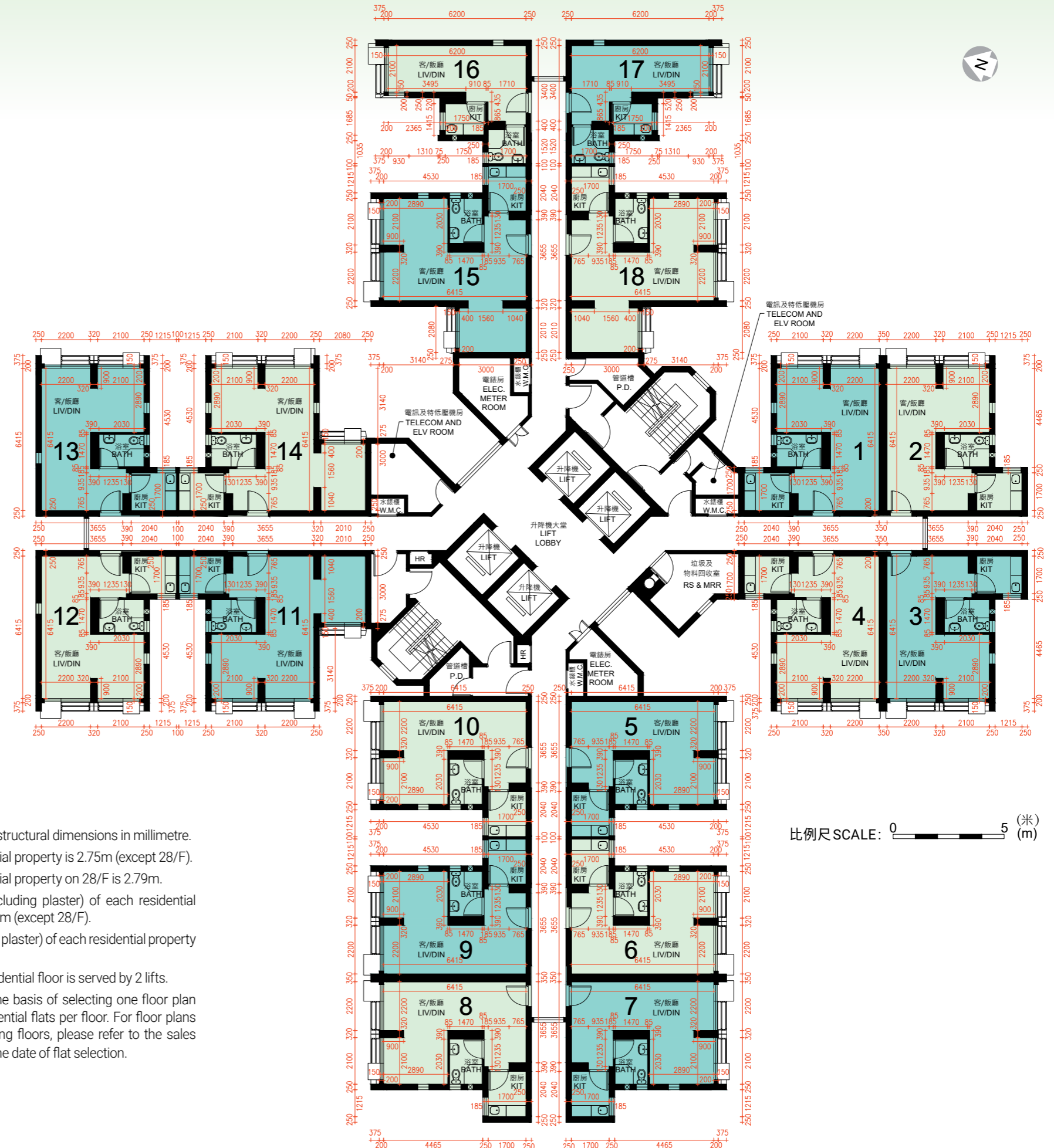

比例尺 SCALE: 0 5 (米)

B 座標準樓層平面圖 (3樓至28樓)

Block B Typical Floor Plan (3/F-28/F)

圖例 NOTATION

| | | |
|----------------------|----------|---|
| BATH | 浴室 | Bathroom |
| ELEC. METER ROOM | 電錶房 | Electrical Meter Room |
| HR | 消防喉轆 | Hose Reel |
| KIT | 廚房 | Kitchen |
| LIV/DIN | 客/飯廳 | Living/Dining Room |
| P.D. | 管道槽 | Pipe Duct |
| RS & MRR | 垃圾及物料回收室 | Refuse Storage and Material Recovery Room |
| TELECOM AND ELV ROOM | 電訊及特低壓機房 | Telecommunications and Extra Low Voltage Room |
| W.M.C. | 水錶櫃 | Water Meter Cupboard |
| | 固定窗 | Fixed Window |

註:

1. 平面圖所列之數字為以毫米標示之建築結構尺寸。
2. 每個住宅物業的層與層之間的高度為2.75米(28樓除外)。
28樓每個住宅物業的層與層之間的高度為2.79米。
3. 每個住宅物業的樓板(不包括灰泥)的厚度為160毫米、195毫米及250毫米(28樓除外)。
28樓每個住宅物業的樓板(不包括灰泥)的厚度為200毫米。
4. 大廈設有4部升降機。每個住宅樓層均有2部升降機到達。
5. 為減低道路交通噪音的影響,部分單位將設有固定窗。
6. 此標準樓層平面圖是根據揀選一張可顯示每層最多住宅單位的圖則而選定。其他位於其餘樓層的住宅單位平面圖,請參閱將在選購單位日期前提供的售樓說明書。

Notes:

1. The dimensions on the floor plan are all structural dimensions in millimetre.
2. The floor-to-floor height of each residential property is 2.75m (except 28/F).
The floor-to-floor height of each residential property on 28/F is 2.79m.
3. The thicknesses of the floor slabs (excluding plaster) of each residential property are 160mm, 195mm and 250mm (except 28/F).
The thickness of the floor slab (excluding plaster) of each residential property on 28/F is 200 mm.
4. There are 4 lifts in the building. Each residential floor is served by 2 lifts.
5. In order to mitigate the impact of road traffic noise, fixed windows are provided in some flats.
6. This Typical Floor Plan is selected on the basis of selecting one floor plan which shows the most number of residential flats per floor. For floor plans of other residential flats on the remaining floors, please refer to the sales brochure which will be available before the date of flat selection.

